

Surface Mounting Hand Sensor-IR006

Description	Dimension	Voltage	Load
Hand & Door Sensor switch	45mm x 54mm	12-24VDC	Max. 4 Amps.

Function:

The led lamp connected to the output of the IR sensor switch will turn on when the hand pass over the detector within 10cm in distance and will turn off when the hand pass over the detector again.



Installation Instructions:

Step 1: Install the holder part with PIR sensor.

Step 2: Fixing the holder part with two screws(M3x8) onto the wooden plate.

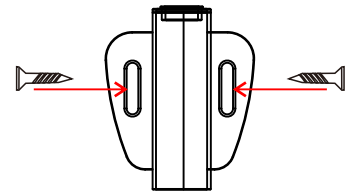

Connector:

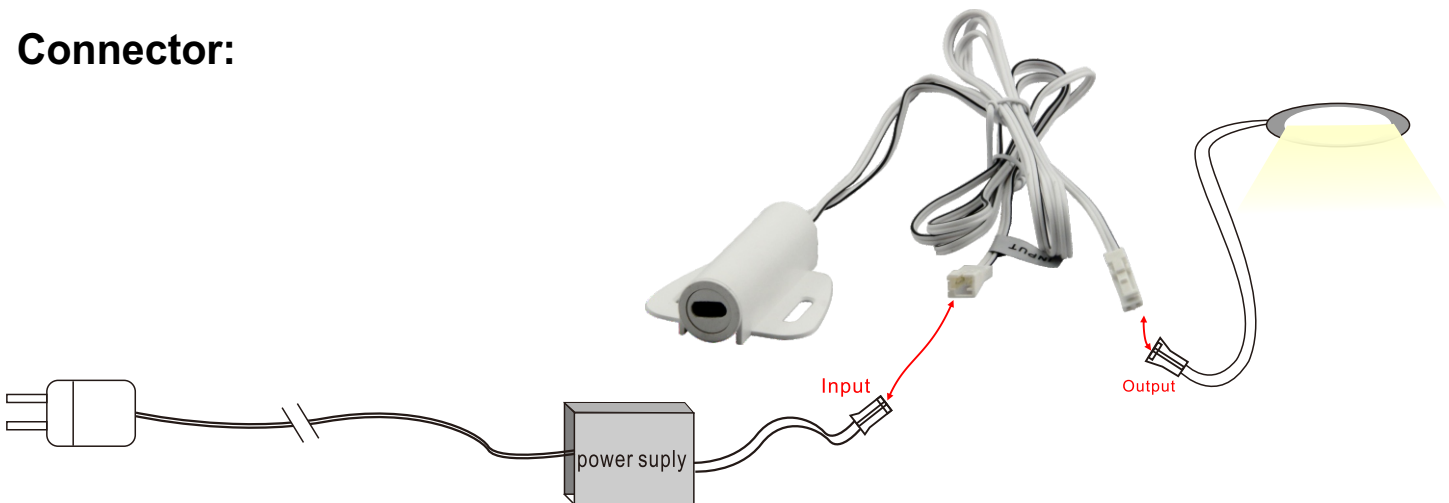

Note: The function/program can be customized made upon different needs, such as longer time for stay on, etc.....

Lister: Lxlan

Assessor: 

Approver: 